

**Revisions**

Issue	Date	Note
1	14/10/2020	See note GTXPDC/221

**ASSEMBLY VIEW**

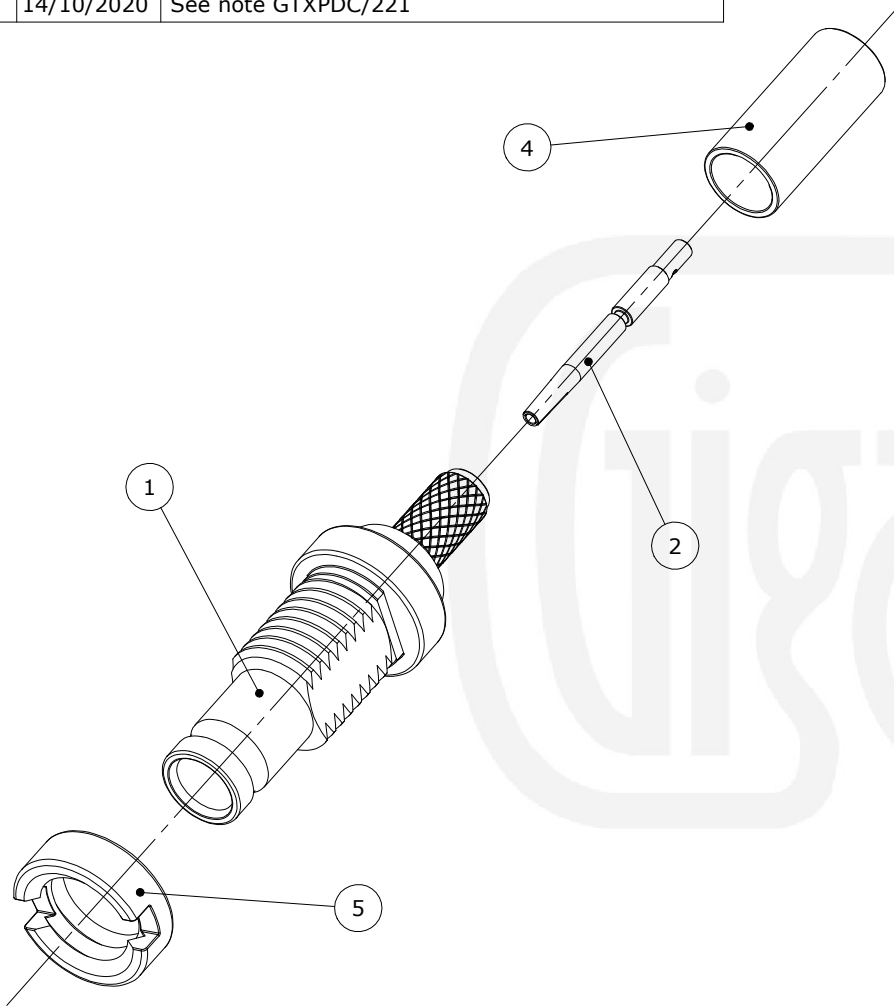

**Assembly Instructions:**

1) Slide the ferrule onto the cable and strip the cable to the dimensions as shown, taking care not to nick the centre conductor or braid

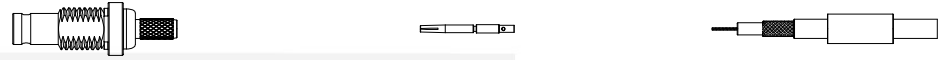

2) Crimp the contact onto the centre core and slide the contact into the body, ensuring that the cable braid is on the outside of the connector mandril and that the contact is fully located

3) Slide the ferrule forward and crimp



**Crimp Hex. Sizes:**

3.25mm Hex, 0.72 Square

**Strip Dimensions:**

A=6.5mm, B=2.5mm, C=2.0mm

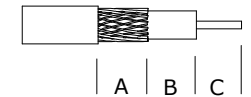

Description	Material	Finish
5 Lock Nut	Brass	Gold
4 Ferrule	Brass	Gold
3 Dielectric	PTFE	White
2 Contact	Beryllium Copper	Gold
1 Body	Brass	Gold

Unless otherwise specified tolerances  
 0.5-5 = ±0.2  
 >5-30 = ±0.4  
 >30-120 = ±0.6  
 >120-315 = ±1.0  
 >315-1000 = ±1.6  
 Angles = ±5°  
 Units = mm

This document is the confidential property of Gigatronix Limited and may not be copied, reproduced or transmitted to any third party without written authorisation.



<b>Author</b>	PJP
<b>Drawn by</b>	PJP
<b>Drawing date</b>	14/10/2020
<b>Checked by</b>	SM
<b>Checked date</b>	14/10/2020
<b>Scale</b>	Not to scale

<b>Part Number</b>	2302-0179-C01
<b>Title:</b>	1.0/2.3 12G SDI Crimp Bulkhead Jack, RG179, Belden RG179DT